



# Technical Bulletin

Place a copy of this bulletin in the front of each Blueprints Manual.  
 Redline drawings as needed and include a TB reference note.  
 Reference TB implementation on site Action Item Box-chart and/or  
 site tool history management log.

**Number:** 064  
**Date Issued:** 06/13/07  
**Expiration Date:** None

<b>Subject/Key Words:</b>	GAMA Robot Horizontal Gear Head Replacement; Motor Mounting Plate. Older Systems			
<b>Classification:</b>	<input checked="" type="checkbox"/> Informational	<input type="checkbox"/> Mandatory	<input type="checkbox"/> Safety Alert	<input type="checkbox"/> PM Impact
	<input type="checkbox"/> Warranty Impact	<input type="checkbox"/> Purchase Parts	<input type="checkbox"/> No Charge For Parts expires ___/___/___. Reference this TB# when ordering NC parts.	
<b>Parts/Reference Documents:</b>	RBT1A0012 – Gear Head GAMA Horizontal Right RBT2B0452 – Motor Mounting Plate X-Motion			

**Issue/Symptoms:**

After replacement of a GAMA Robot Horizontal Gear Head (RBT1A0012), the new gear head binds against its motor mounting plate. The motor gear head design was changed by the OEM supplier. The “new” motor gear head (which has actually been in use for around ten years) has a slightly raised shoulder around the drive shaft. This shoulder is wider than the 1.25” diameter through-hole in the original mounting plate. If the older mounting plate is not replaced, the result is a poor fit that leads to binding problems.

**Inspection:**

Measure the diameter of the through-hole in the existing motor mounting plate. If it measures 1.25”, it must be replaced with Akrion PN RBT2B0452, a newer mounting plate with a through-hole diameter of 1.75”. Systems manufactured after the switch to the raised shoulder motor design may be equipped with this newer style mounting plate.

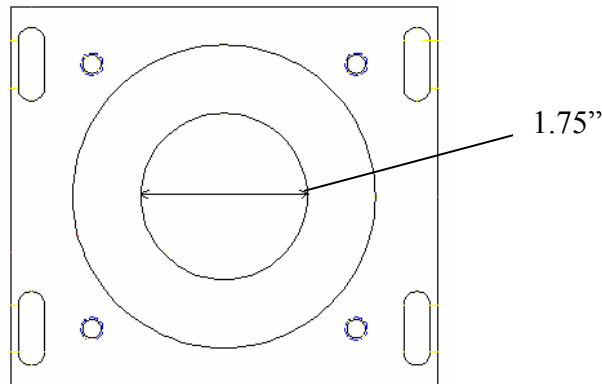

**Solution:**

Perform inspection as outlined above and order motor mounting plate RBT2B0452 as required when ordering a replacement GAMA robot horizontal gear head RBT1A0012.

If you have technical questions or require more information, please contact Akrion Technical Support Department via e-mail at [techsupport@akrion.com](mailto:techsupport@akrion.com). Authorized service personnel can obtain copies of the latest Akrion procedures and controlled documents from the Akrion Document Control department at [doccontrol@akrion.com](mailto:doccontrol@akrion.com). Customers must direct all inquires to their local Akrion field service representative. (Form QA1656F1AC)